



# Bective View

Kingsthorpe, Northampton

oriordanbond  
SALES & LETTINGS



## Bective View

Kingsthorpe  
NN2 7TE

Price  
£285,000

**A well presented three bedroom family home, located in the heart of Kingsthorpe, within walking distance to ample shops, schools and amenities.**

Accommodation comprises entrance hall, modern kitchen, separate utility room and study, cloakroom/WC and a large open plan sitting/dining room. From the first floor landing are three bedroom with master bedroom benefitting from a shower en-suite and a family bathroom. Outside is a private low maintenance rear garden. To the front of the property is a driveway providing off road parking. Further benefits include uPVC double glazing and gas radiator heating. (B/1077/S)

- Well presented three bedroom family home
- En-suite to master bedroom
- Separate utility room and study
- Gas radiator heating
- Low maintenance rear garden
- Off road parking





GROUND FLOOR  
568 sq.ft. (52.8 sq.m.) approx.

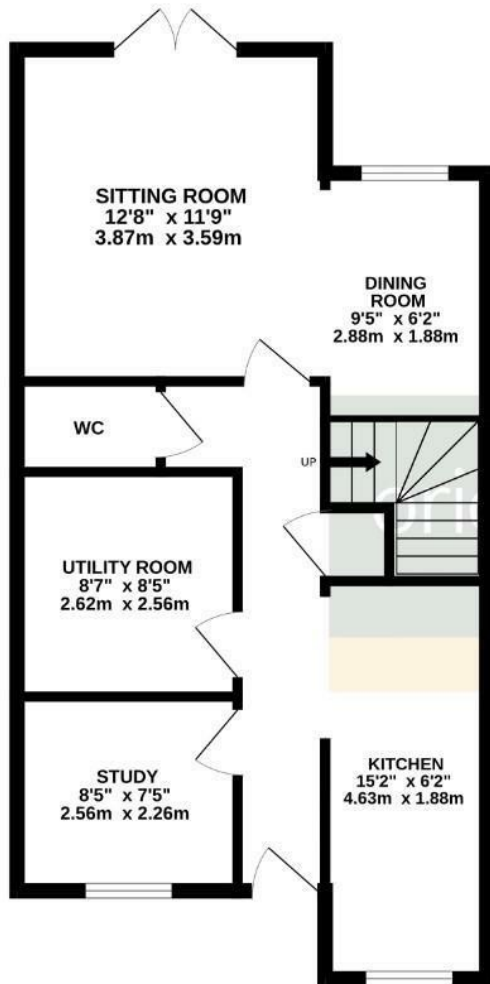

1ST FLOOR  
509 sq.ft. (47.3 sq.m.) approx.

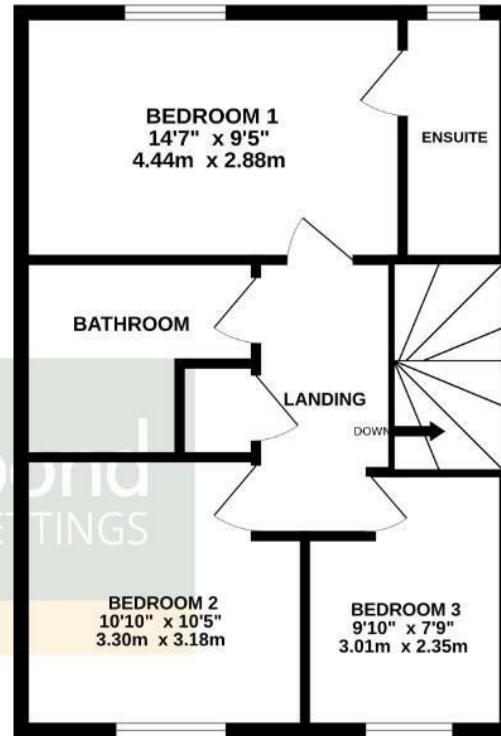

TOTAL FLOOR AREA : 1077 sq.ft. (100.1 sq.m.) approx.

Whilst every attempt has been made to ensure the accuracy of the floorplan contained here, measurements of doors, windows, rooms and any other items are approximate and no responsibility is taken for any error, omission or mis-statement. This plan is for illustrative purposes only and should be used as such by any prospective purchaser. The services, systems and appliances shown have not been tested and no guarantee as to their operability or efficiency can be given.  
Made with Metropix ©2026



**Additional information**

- Council Tax Band: C
- Energy Efficiency Rating:

**Viewing**

Viewing strictly by appointment – details below

**Disclaimer**

O’Riordan Bond Estate Agents Limited has not tested apparatus, equipment, fittings or services and so cannot verify they are in working order. The buyer is advised to obtain verification from their solicitor or surveyor.

**O’Riordan Bond Kingsthorpe Sales**

**01604 722007**

[kingsthorpe@oriordanbond.co.uk](mailto:kingsthorpe@oriordanbond.co.uk)

